

Gu~~itar~~Fetish

.COM

BHM SERIES WIRING DIAGRAM

The BHM pickguard allows you to install the classic "Series-Phase" wiring scheme made popular by Brian May on any Stratocaster style guitar. You do NOT need to modify your guitar, our mini switches allow this scheme to fit into a standard Strat cavity.

While we have designed this kit to fit ANY standard Strat pickup- the unique tones made popular by Brian with Queen are really only available with warm, sweet lower output pickups with a relaxed midrange and an extended "Hi Fi" high end response. Therefore we ONLY can recommend that you use GFS "Brighton Rock" pickups to get the classic tones.

For the most authentic tones you'll want to use three 6.5K Brighton Rocks- For the most versatile modern rock tones you'd want the calibrated set of 8K bridge pickup, reverse wound 7.5K Middle pickup and classic 6.5K neck pickup.

In order to install this kit you will need a VERY high quality soldering iron with a pencil tip- we suggest you only use a higher end Weller, Unger or Xytronics gun. You want high heat for a very short duration. We also suggest you use a high quality sideways cuticle clippers to slip the wire on the switches, a needle nose pliers or metal tweezers for arranging the wires, and a high quality wire stripper. You will need to make very precise cuts and bends, so please- be PATIENT... set aside at least 2 hours to complete just the wiring section of this kit.

Please remember- You always want to pre-tin every peice of wire and every switch position with solder before soldering- then use high heat for the BRIEFEST of durations- this will result in a clean and neat installation.

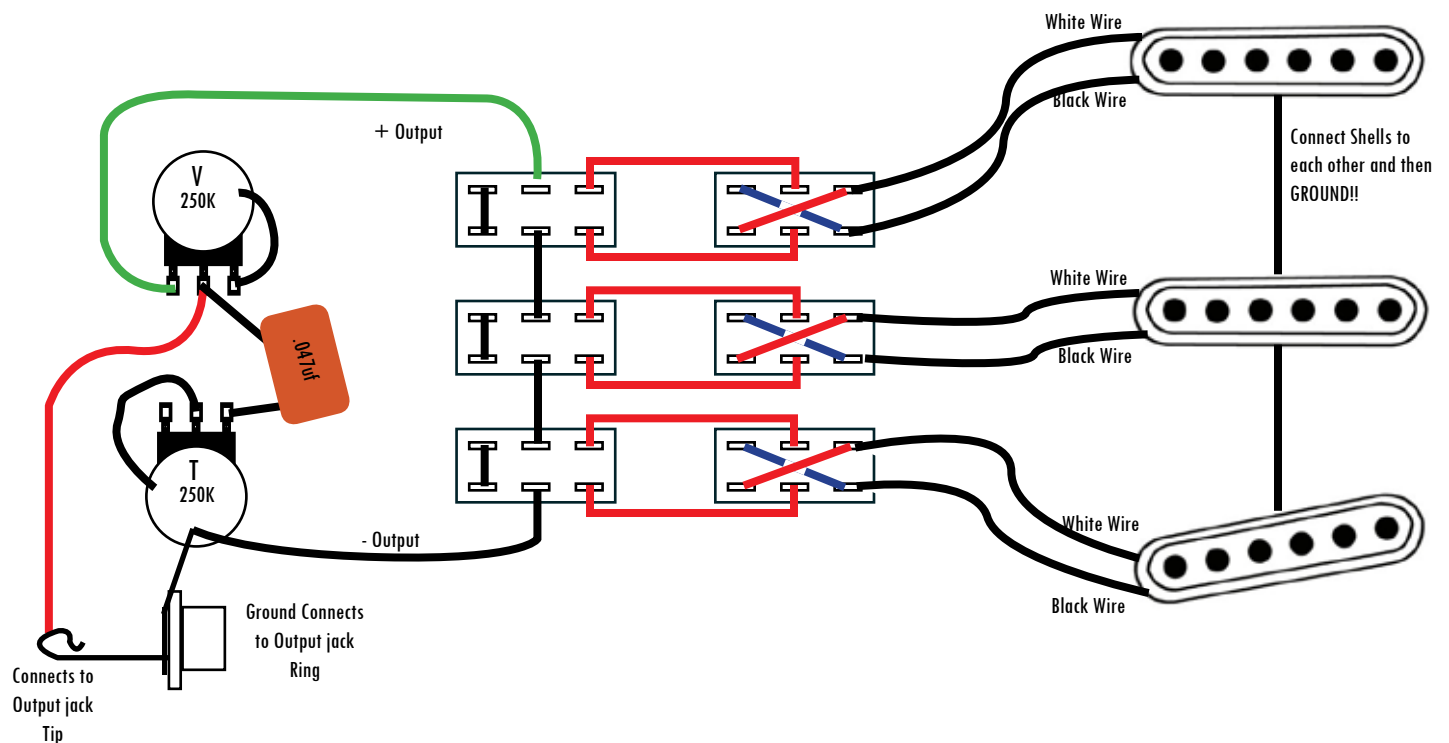
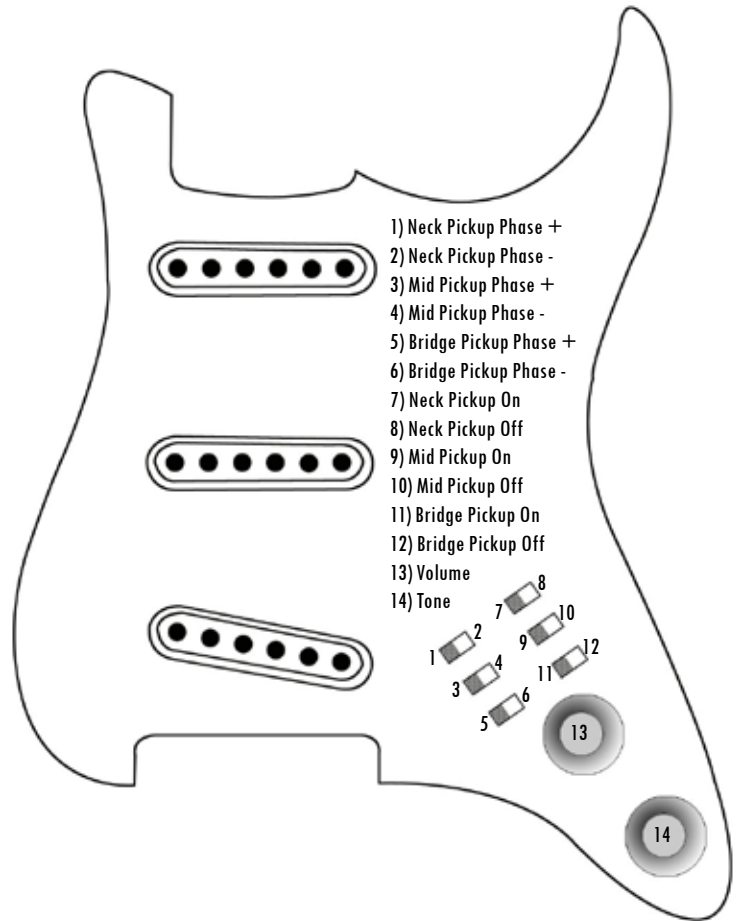

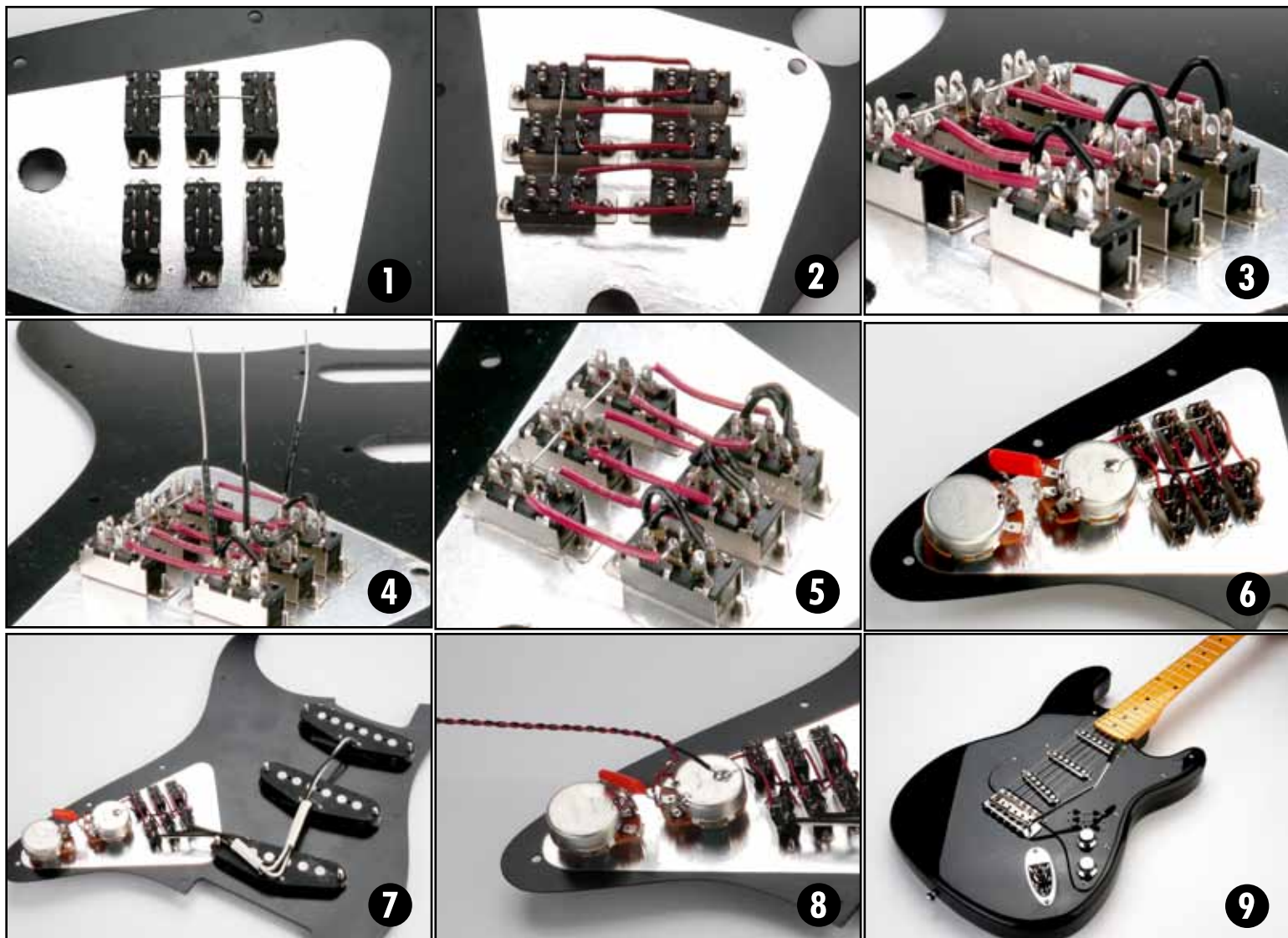

1) Install all six switches. They are not directional so it does not matter how they point. Once all six are installed insert a piece of bus wire (Silver) all the way through the MIDDLE row of the On/Off switches. Solder ONLY the tabs that face another switch- so the outside tabs get no solder. Once done clip off any wire remaining so you are left with ONLY two wires connecting the outside switches with the center switch as shown.

2) Carefully make up 6 short jumper wires from the red solid core wire provided. Each piece should be 7/8" long with a small amount of stripped wire at the end. These will be soldered from the CENTER tabs of the phase switches to the top tabs of the on/off switches as shown. Clip off any remaining wire.

3) Start installing your "criss-cross" jumpers. This is very delicate- First prefab up some black wire with only 1/2" of insulation and 3/4" of stripped wire on each end. Feed the wire through the Phase switch terminals at the upper right and lower left. (Refer to the image on page 1) Solder these wires and clip off any remaining wire.

4) Now you need to install the other criss-cross wire- this will "fly over" the first one- The easiest way is to solder one end to the lower right terminal, then using the at least 3/4" of uninsulated wire, feed it through the upper left hole- once it is pulled through nice and tight solder in place and clip off any remaining wire.

5) This is what you should have now- it is important to double check your connections, make sure everything is solid but most importantly- make sure NOTHING is shorting out- It's very easy to have a block of solder touching something else at this point.

6) Now install the pots with the lugs facing each other. Notice the ground wire we have going from the back of the pot (Either pot is OK) to the center tab of the On/Off switch at top. Then you need to install the volume pot wire- This connects to the center lug of the switch on the bottom left- and connects to the left lug of the pot. The cap solders between the center tab of the volume pot and the left tab of the tone pot. Bend back the center tab of the tone pot and the right tab of the volume opt and solder them to their respective cases.

7) Now install the pickups- PLEASE NOTE!! If using Brighton Rock Pickups YOU MUST cut the wire that connects the shell to the black wire- Solder the shells to each other using black wire, then connect to ground- but they MUST NOT be common with either pickup lead.

8) Here's your lead that solders to your output jack- The Hot lead (Red) solder to the center tab of the volume pot- this will be common with one leg of the cap. The ground lead (Black) solders to the case.

9) Here's your finished product- double check that each position works as intended before buttoning her up.